

# Mae Fah Laung-Chiang Rai International Airport / Aerodrome Ground Movement Chart

DIMENSIONS IN METRES

MAG VAR 1° 3' W (2025)  
ANNUAL CHANGE 0° 1' E  
AERODROME ELEVATION 1280 ft

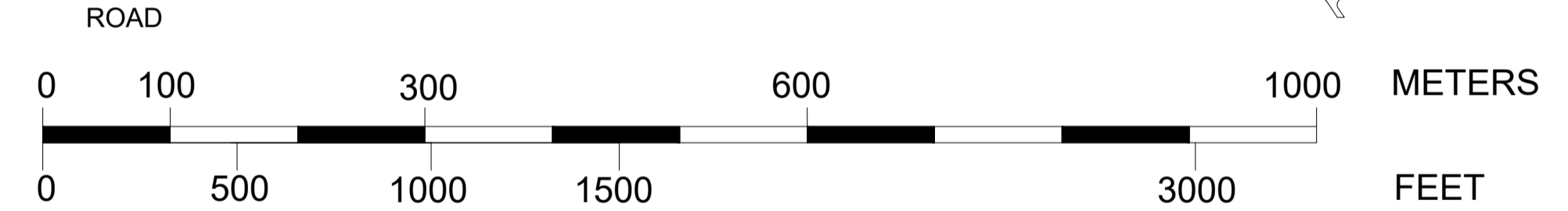
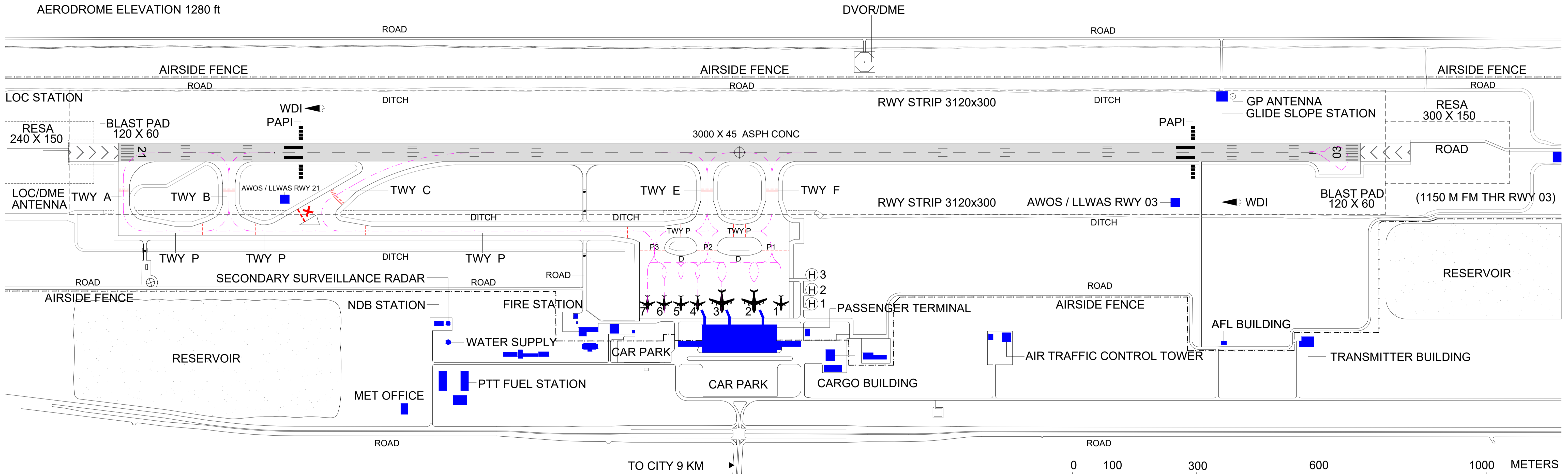

LEGEND	
AERODROME REFERENCE POINT	19 57 08 N 99 52 59 E
BUILDING OR LARGE STRUCTURE	[Blue square symbol]
TAXI ROUTES	[Dashed line symbol]
HELICOPTER STAND AND IDENTIFICATION	(H) 1
AIRCRAFT STAND AND IDENTIFICATION	[Airplane symbol] 1
RUNWAY HOLDING POSITION	[Red lines symbol]
INTERMEDIATE HOLDING POSITION	[Red dashed lines symbol]
WIND DIRECTION INDICATOR (LIGHTED)	[Wind indicator symbol]
ANTENNA	[Circle with dot symbol]
CLOSED TAXIWAY	[Red X symbol]

TAXIWAYS ; STRENGTH, SURFACE AND WIDTH		
ID	PCN-SFC	WIDTH (M)
A	PCR 1500/R/D/W/T	27.5
B	PCR 1500/R/D/W/T	30
C	PCR 1500/R/D/W/T	35
E	PCR 1500/R/D/W/T	30
F	PCR 1500/R/D/W/T	30
P	PCR 1500/R/D/W/T	23
P1	PCR 1500/R/D/W/T	48
P2	PCR 1500/R/D/W/T	48
P2	PCR 1500/R/D/W/T	48.2

- REMARK :
- SITE OF ARP CENTER LINE OF RUNWAY 1500 M FM THR RWY 21
  - RUNWAY SURFACE : ASPH CONC STRENGTH : PCR 1000/F/A/X/T
  - ACFT STAND NR 2,3 AND 4 AVAILABLE WITH SINGLE-END PASSENGER LOADING BRIDGES
  - ALL ACFT STAND IS NOSE-IN PARKING
  - ENGINE RUN-UP AREA LOCATED ON THE BEGINNING OF RWY 21 (FACE SOUTH)
  - THE PORTION OF TAXIWAY C LEADING TO THE NORTH WILL BE CLOSED
  - ACFT CODE LETTER C AND D MUST BACKTRACK ON RWY TURN PAD ONLY WHEN RWY 21 IS IN USE FOR ARRIVING
  - RWY TURN PAD AT THE END OF RWY 21 USED ONLY FOR ACFT WITH OUTER MAIN GEAR WHEEL SPAN (OMGWS) LESS THAN 9M
  - TWY C USED FOR EXIT FROM RWY ONLY

CHANGE : TWY D LOCATION, TWY E , F , P1 , P2 , P3 INFORMATION.