

RWY	DIRECTION	THR	BEARING	STRENGTH
01	15°	13° 39' 24" N 100° 45' 07" E	PCR 1650/F/D/X/T	
19	195°	13° 41' 30" N 100° 45' 40" E		
02R	15°	13° 40' 17" N 100° 44' 05" E	PCR 1650/F/D/X/T	
20L	195°	13° 42' 13" N 100° 44' 35" E		
02L	15°	13° 39' 55" N 100° 43' 45" E	PCR 840/F/C/X/T	
20R	195°	13° 42' 01" N 100° 44' 18" E		
TAXIWAYS			BEARING	STRENGTH
SURFACE TYPE	ASPH	PCR 1730/F/D/X/T PCR 870/F/C/X/T		
	CONC	PCR 1660/R/D/W/T PCR 1220/R/C/W/T PCR 900/R/A/W/T		
APRONS			BEARING	STRENGTH
MAIN / EAST / WEST			PCR 1360/R/D/W/T	
SAT - 1			PCR 1010/R/A/W/T	

ELEVATIONS IN FEET  
DIMENSIONS IN METRES  
BEARINGS ARE MAGNETIC

MAG VAR 0°42' W (2025)  
ANNUAL CHANGE 0°2' E

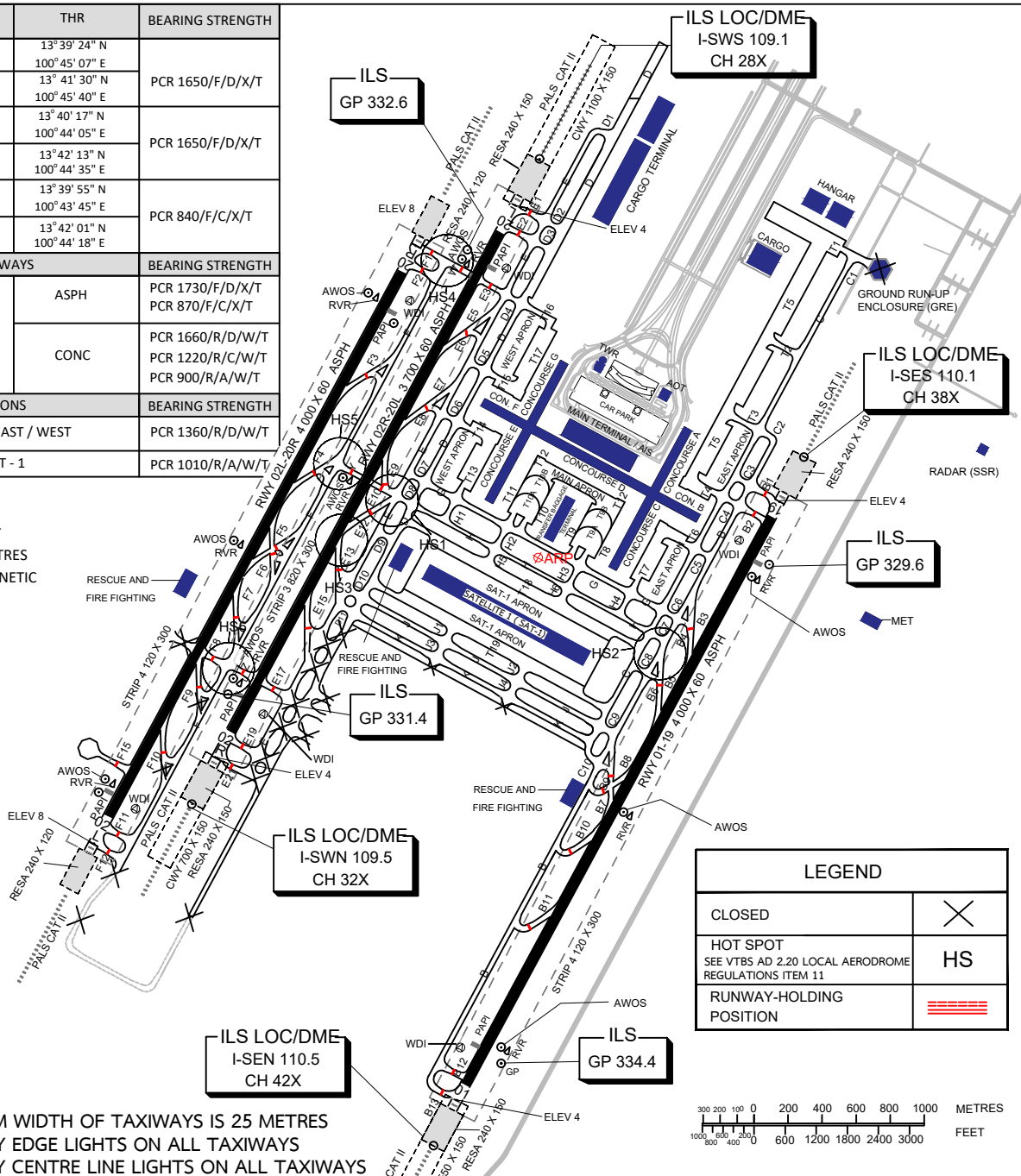

- REMARKS :
- MINIMUM WIDTH OF TAXIWAYS IS 25 METRES
  - TAXIWAY EDGE LIGHTS ON ALL TAXIWAYS
  - TAXIWAY CENTRE LINE LIGHTS ON ALL TAXIWAYS

LEGEND	
CLOSED	✕
HOT SPOT SEE VTBS AD 2.20 LOCAL AERODROME REGULATIONS ITEM 11	HS
RUNWAY-HOLDING POSITION	≡≡≡

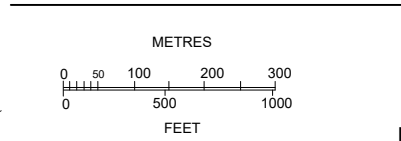
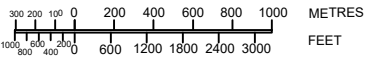

MARKING AND LIGHTING AIDS  
OF ALL RUNWAYS SIMILAR TO RWY 01/19

MARKING AIDS RWY 01/19 AND EXIT TWY

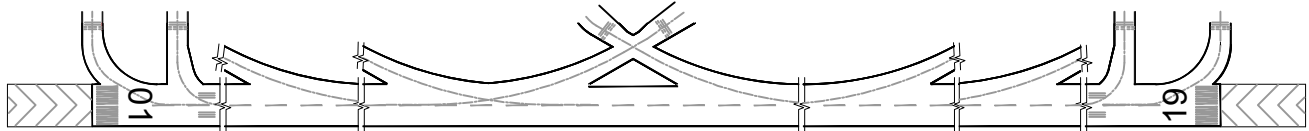

LIGHTING AIDS RWY 01/19 AND EXIT TWY

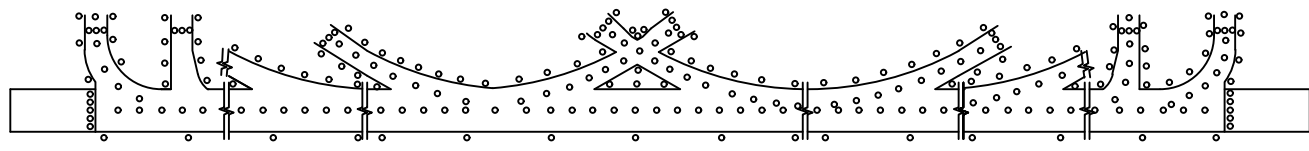

CHANGE - DIRECTION (MAGNETIC BEARINGS), THRESHOLD (GEOGRAPHICAL COORDINATES)