

Phone: +662 568 8831
Fax: +662 576 1903
AFTN: VTBAYOYX
E-mail: aisthai@caat.or.th
ais@caat.or.th

THE CIVIL AVIATION AUTHORITY OF THAILAND
Aeronautical Information Management Department
222 Soi Vibhavadi Rangsit 28,
Vibhavadi Rangsit Rd., Chatuchak,
Chatuchak, Bangkok 10900 Thailand

NON-AIRAC
AIP SUPPLEMENT

A 41/24
25 JUL 2024

**RE-DESIGNATION OF RUNWAY 01R/19L AND 01L/19R
AT SUVARNABHUMI INTERNATIONAL AIRPORT (VTBS)**

1 INTRODUCTION

With effect from 2 October 2024 at 1900UTC to 3 October 2024 at 1000UTC, the purpose of this AIP Supplement is to inform all concerned regarding the re-designation of runway 01R/19L and 01L/19R in relevant to the establishment of the new third runway (runway 02L/20R) since 8 August 2024 at Suvarnabhumi International Airport.

2 RE-DESIGNATION OF RUNWAY 01R/19L AND 01L/19R

From 3 October 2024 at 0000UTC, the two existing runways at Suvarnabhumi International Airport will be re-designated as follows:

- 2.1 The existing runway 01R/19L is re-designated as **RUNWAY 01/19**.
2.2 The existing runway 01L/19R is re-designated as **RUNWAY 02R/20L**.

3 RUNWAY RE-DESIGNATION PROJECT OVERVIEW

To facilitate runway re-designation activities, the following areas will be temporarily closed or available with conditions. For project details, please refer to the table below.

Table: Periods of runway re-designation works

Periods	Date and Time (UTC)	Details
1	2 Oct 2024, 1900 - 2359	Runway 01R/19L will be closed for re-designation. Remark: during this period runway 02L/20R is closed. (refer to attachment 1)
2	3 Oct 2024, 0000 - 0959	- Runway 02R/20L will be partially closed for completion of final re-designation works and not be available for departing or arriving aircraft. - The closed areas will be marked with barricades and closure visual aids. (refer to attachment 2) - The specific taxi route for departing aircraft are as follows Runway 20R: The aircraft will be instructed to taxi via E3, cross runway 20L then W and F1. Runway 02L: The aircraft will be instructed to taxi via E17, cross runway 02R then Z, F and F12. - The specific taxi route for arriving aircraft are as follows Runway 20R: The aircraft will be instructed to taxi via F, Z cross runway 20L, then E17. Runway 02L: The aircraft will be instructed to taxi via F, W, cross runway 02R then E3.
3	From 3 Oct 2024, 1000	Runway re-designation complete. (refer to attachment 3)

4 OTHERS

If unforeseen events such as adverse weather might delay the re-designation works, pilots will be informed of any schedule changes via NOTAM.

5 CONTACT

For further information contact via the following:

Unit: Aeronautical Information Service Sub-Division of Suvarnabhumi International Airport

Tel: +662 132 6931-4

Mobile: +666 2598 0608

E-mail: ais_ytbs@airportthai.co.th



6 VALIDITY

This AIP Supplement will remain current until 3 October 2024 at 1000UTC. Any changes to this AIP Supplement will be notified by NOTAM.

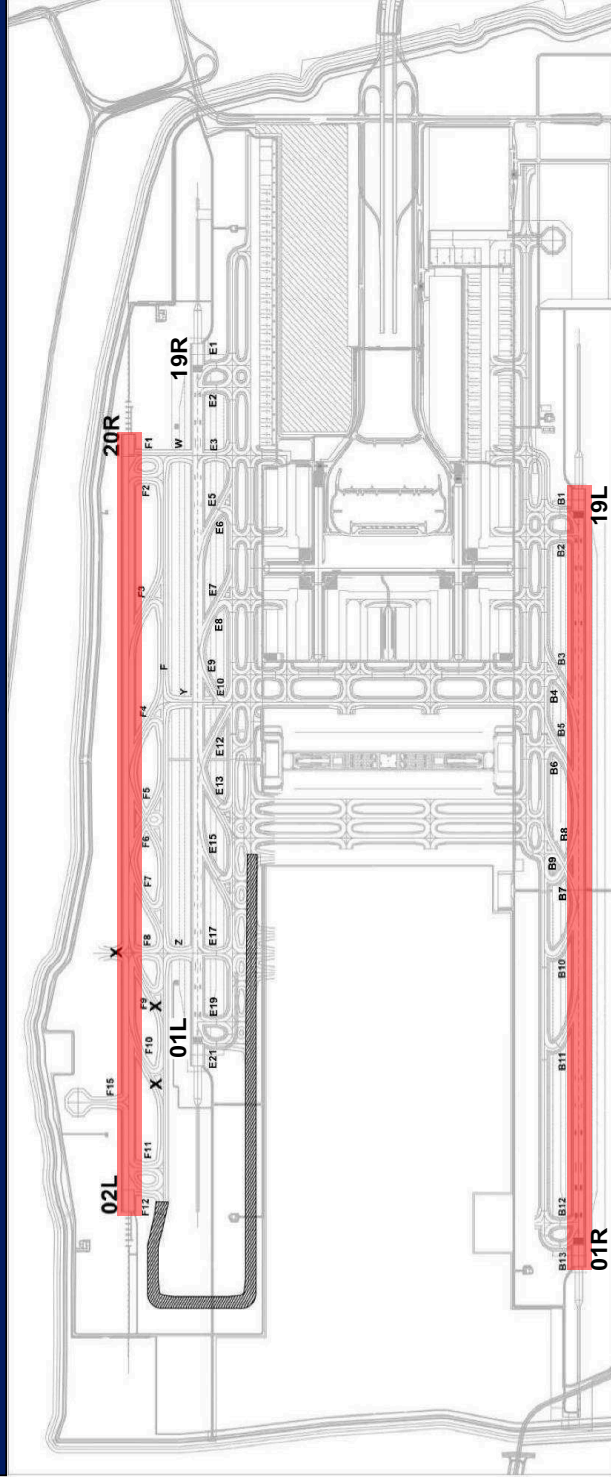
Period 1
Runway 01R/19L closure for re-designation on 2 Oct 2024, 1900 - 2359UTC





Remark: during this period runway 02L/20R is closed.

-  Closure area
-  Closure marking

Period 2

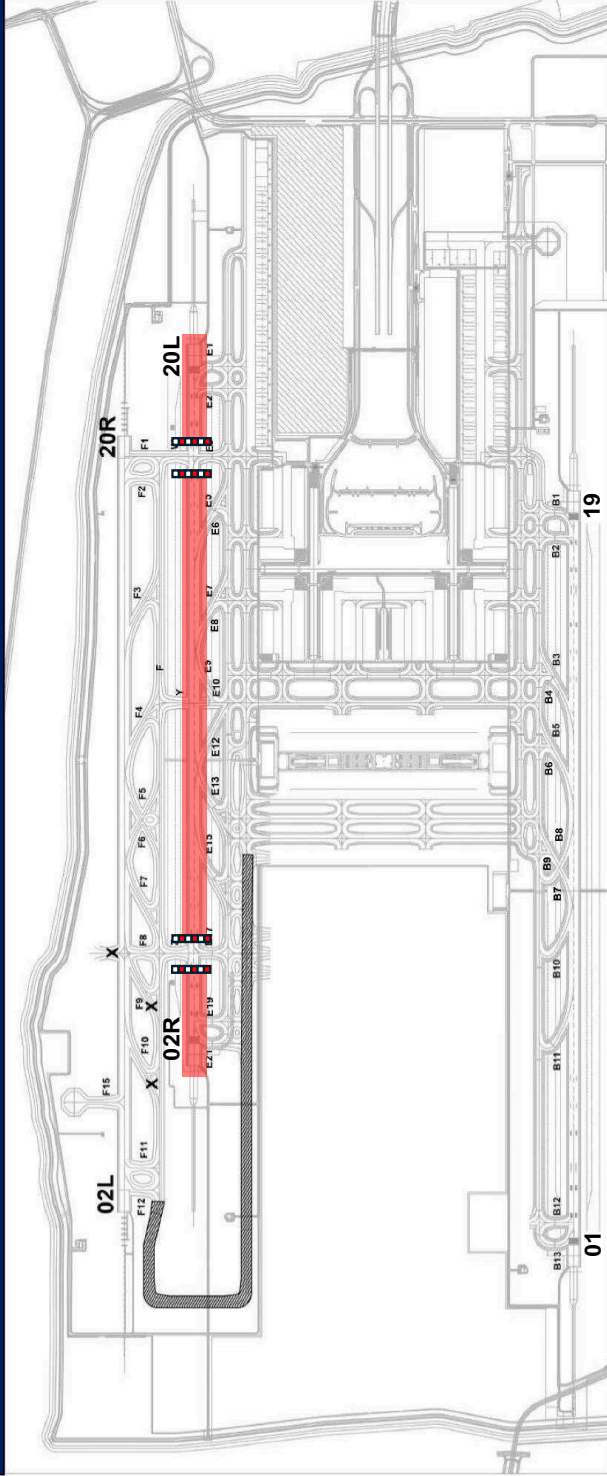
Runway 02R/20L will be partially closed for completion of final re-designation works on 3 Oct 2024, 0000 - 0959UTC



-  Closure area
-  Barricade
-  Closure marking

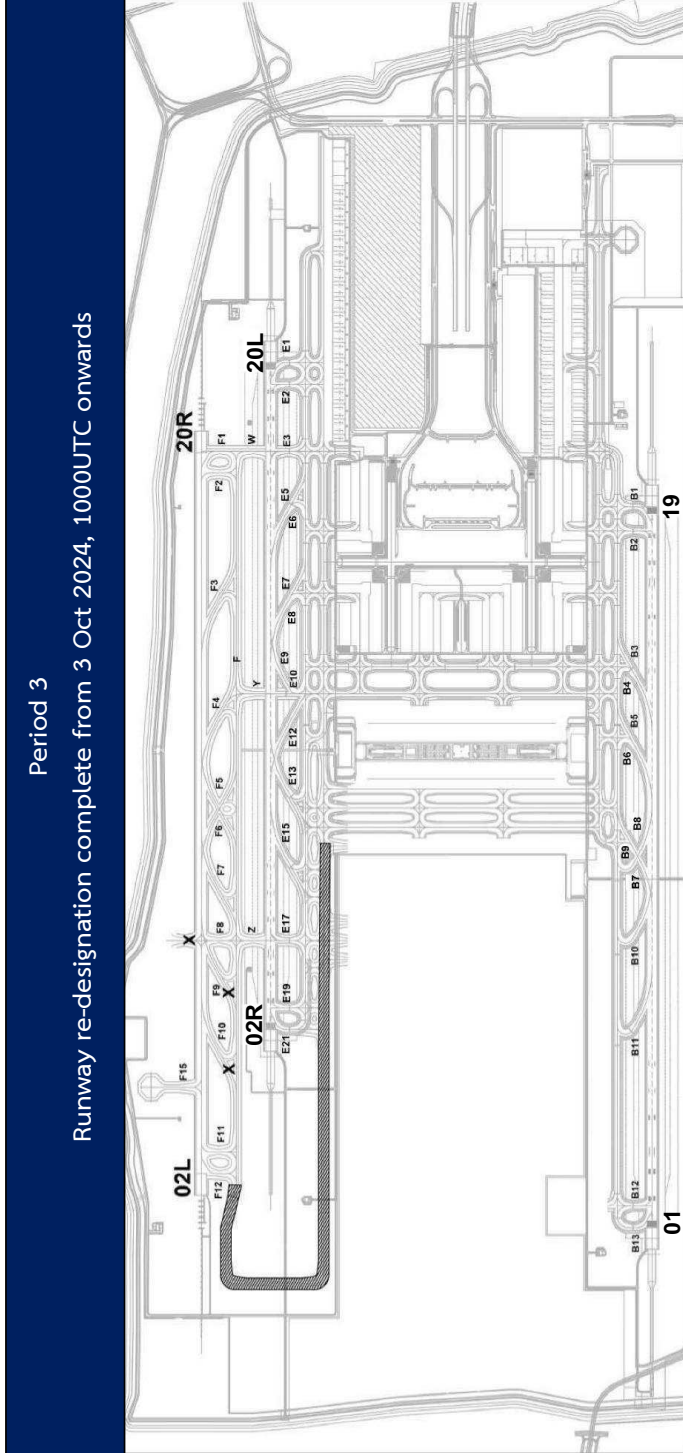

X Closure marking