

Phone: +662 568 8831
Fax: +662 576 1903
AFTN: VTBAYOYX
E-mail: aisthai@caat.or.th
ais@caat.or.th

THE CIVIL AVIATION AUTHORITY OF THAILAND
Aeronautical Information Management Department
222 Soi Vibhavadi Rangsit 28,
Vibhavadi Rangsit Rd., Chatuchak,
Chatuchak, Bangkok 10900 Thailand

AIRAC
AIP SUPPLEMENT

A 09/24
11 JAN 2024

THE TEMPORARY FENCES INSTALLED ALONG TAXIWAY K AND TAXIWAY D11
AT SUVARNABHUMI INTERNATIONAL AIRPORT (VTBS)

1 INTRODUCTION

With effect from 22 February 2024 at 0000 UTC, the purpose of this AIRAC AIP Supplement is to inform all concerned regarding the temporary fences installed for construction area at Suvarnabhumi International Airport.

2 DETAILS

- 2.1 The temporary fences are installed along the south side of taxiway K and taxiway D11 with distance 43.5, 45 and 51 metres from taxiway centre line.
- 2.2 The dimension of fences is 3 metre-high painted in alternate band of red and white, fences will be lighted by omni-directional fixed red lights spacing every 7.5 metres at night and during limited visibility conditions.
- 2.3 The layout is shown in attachment A1 - A2.

3 PRECAUTIONS

Taxiway K and taxiway D11, if available for traffic, can accommodate aircraft up to code E.

4 CONTACT

For further information contact via the following:

Unit: Aeronautical Information Service Sub-Division of Suvarnabhumi International Airport

Tel: +662 132 6931-4

Mobile: +666 2598 0608

E-mail: ais_vtbs@airportthai.co.th

5 VALIDITY

This AIRAC AIP Supplement will remain current until further advised. Any changes to this AIP Supplement will be notified by NOTAM.

LOCATION OF THE TEMPORARY FENCES

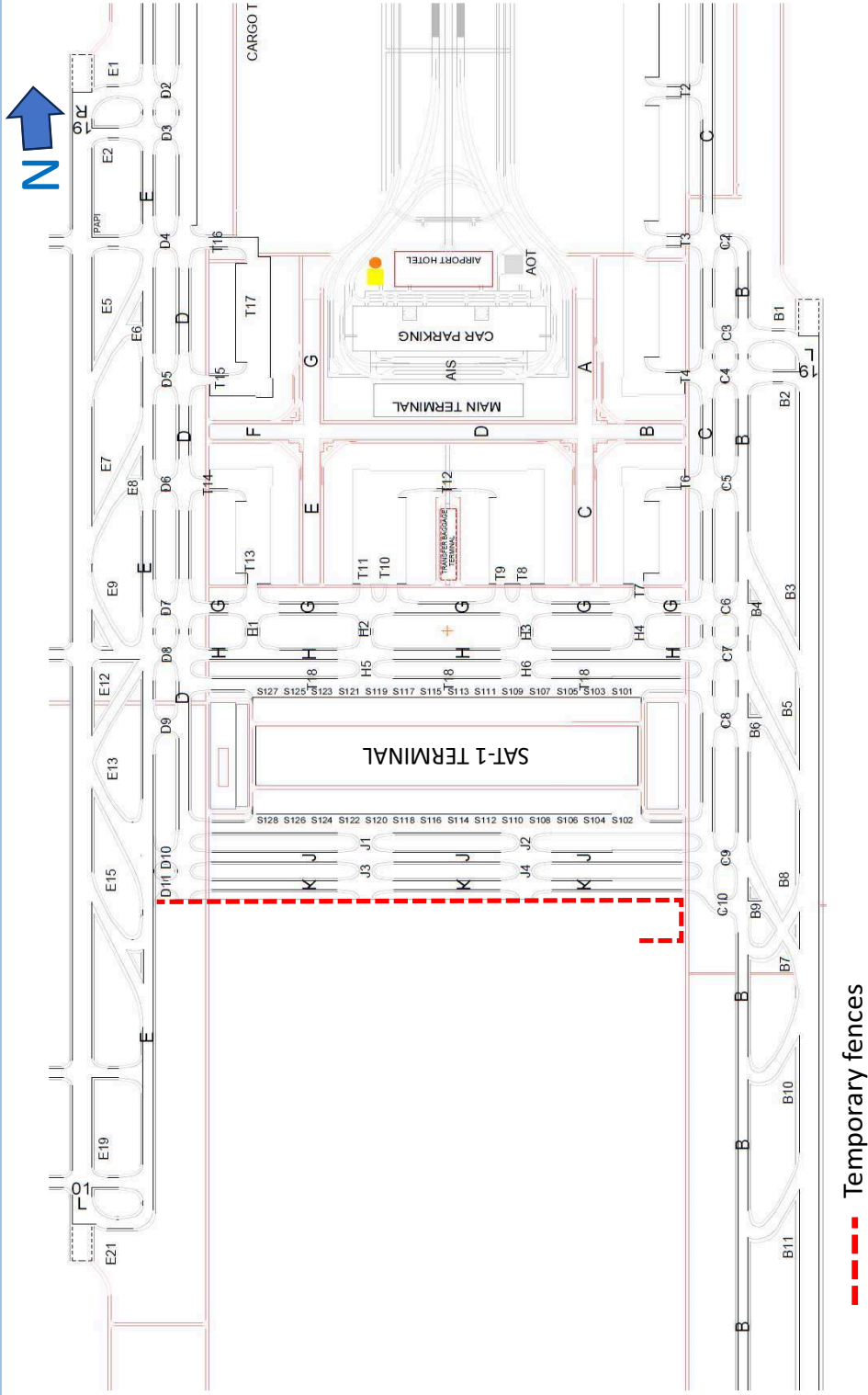



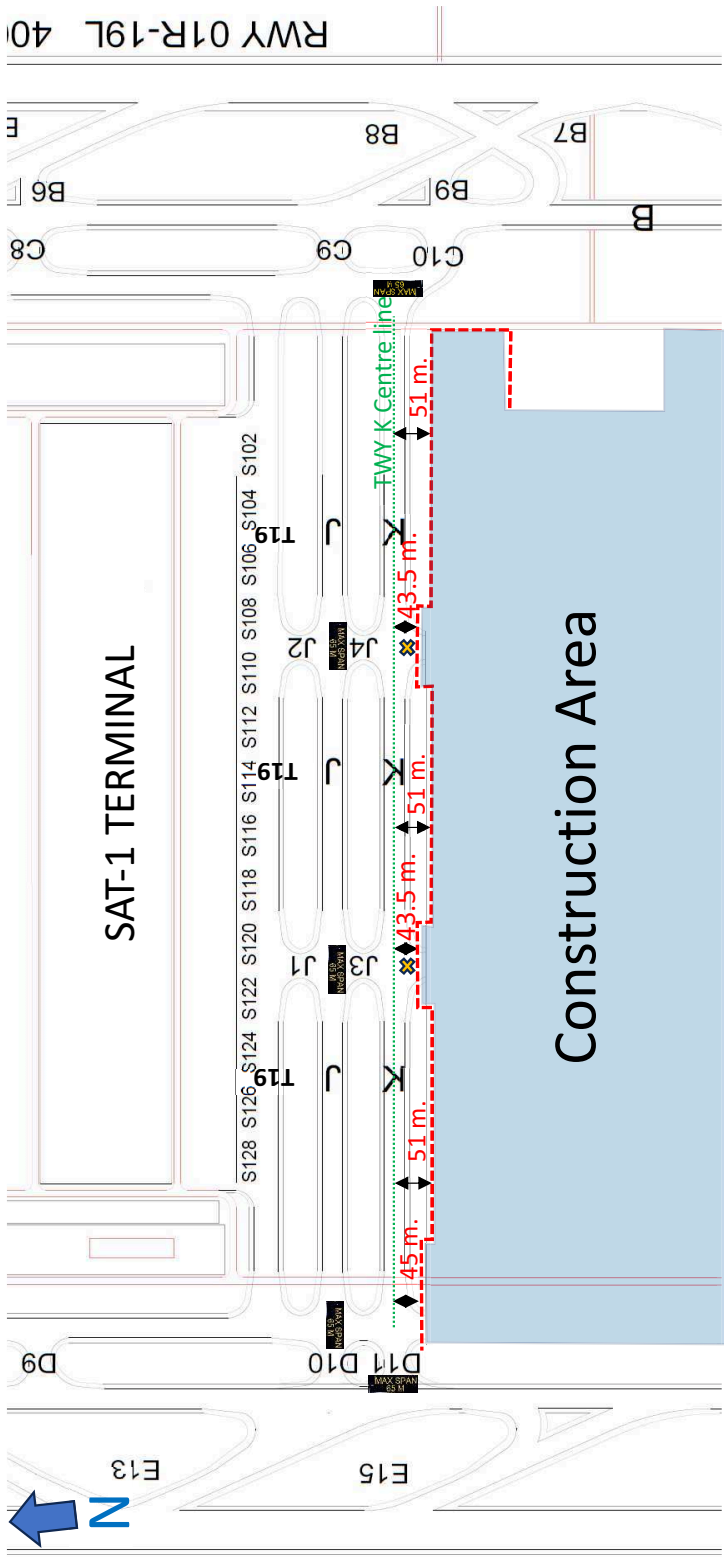

--- Temporary fences

TEMPORARY FENCES INSTALLED FOR CONSTRUCTION AREA ATTACHMENT A2

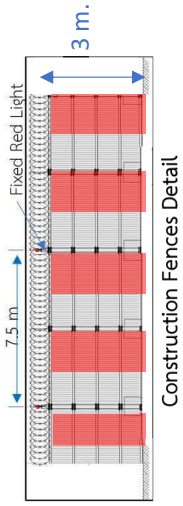

**MAX SPAN
65 M**



-  Construction Area
-  Temporary fences
-  Closure Marking