

RWY	DIRECTION (TRUE BRG)	THR	BEARING STRENGTH
05	46	17 11 12.56 N 104 06 35.89 E	PCN 43/F/D/X/T
23	226	17 12 12.45 N 104 07 38.22 E	
TAXIWAY A,B,C			PCN 43/F/D/X/T
TAXIWAY D			PCN 46/F/C/X/T
APRON A (EAST)			PCN 47/R/D/X/T
APRON A (WEST)			PCN 47/R/C/X/T
APRON B			PCN 47/R/D/X/T

MAG VAR 0.93°W (2016)
ANNUAL RATE OF CHANGE 0.02°W

**DVOR/DME
SKN 114.2
CH 89X**

ELEVATIONS IN FEET AND DIMENSIONS IN METRES

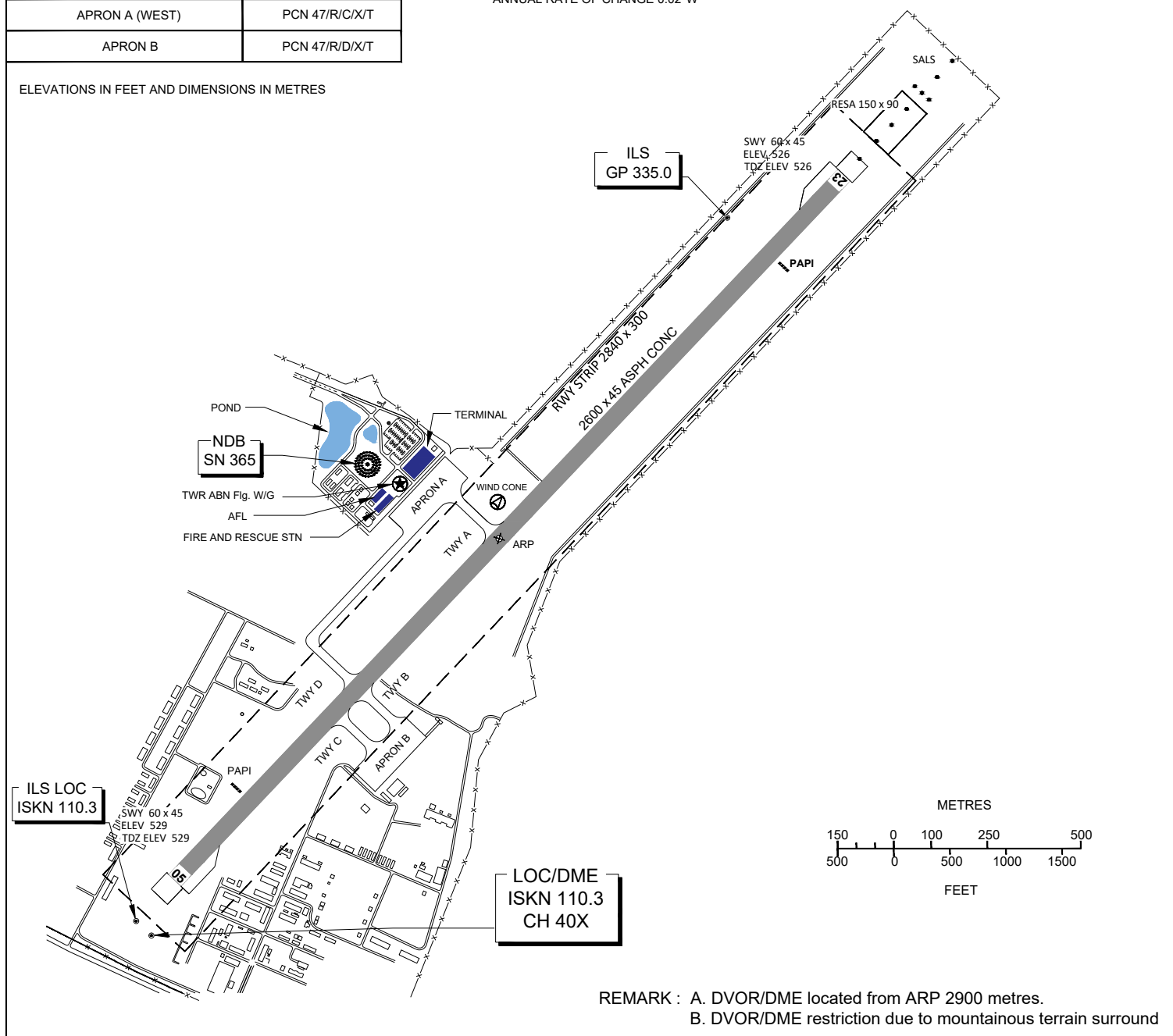

REMARK : A. DVOR/DME located from ARP 2900 metres.
B. DVOR/DME restriction due to mountainous terrain surround

MARKING AIDS RWY 05/23 AND EXIT TWY

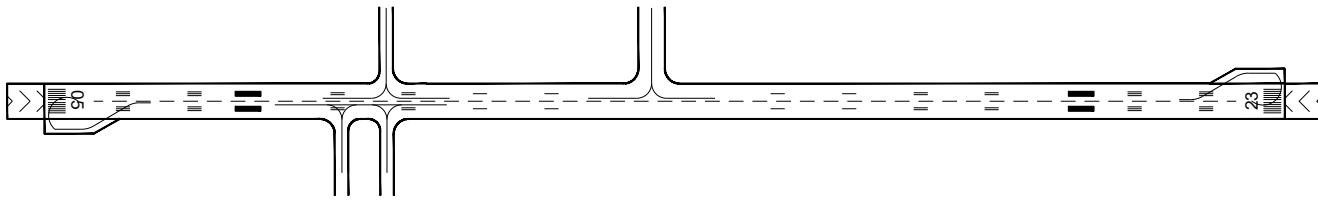

LIGHTING AIDS RWY 05/23 AND EXIT TWY

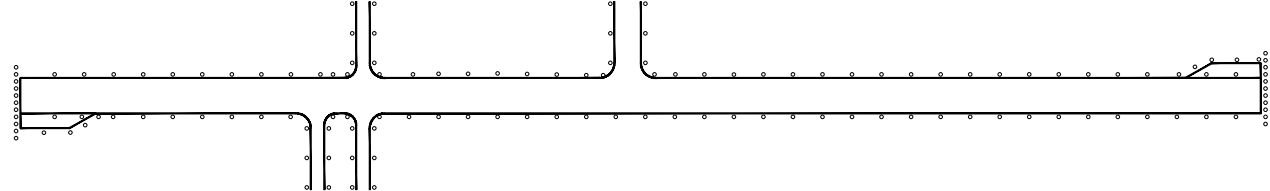

CHANGE : REVISED CHART. MAG VAR. ANNUAL RATE OF CHANGE. TWY D ADDED. FENCE ADDED. TABULAR INFO. PAPI.